

PLAN
Scale 1:50

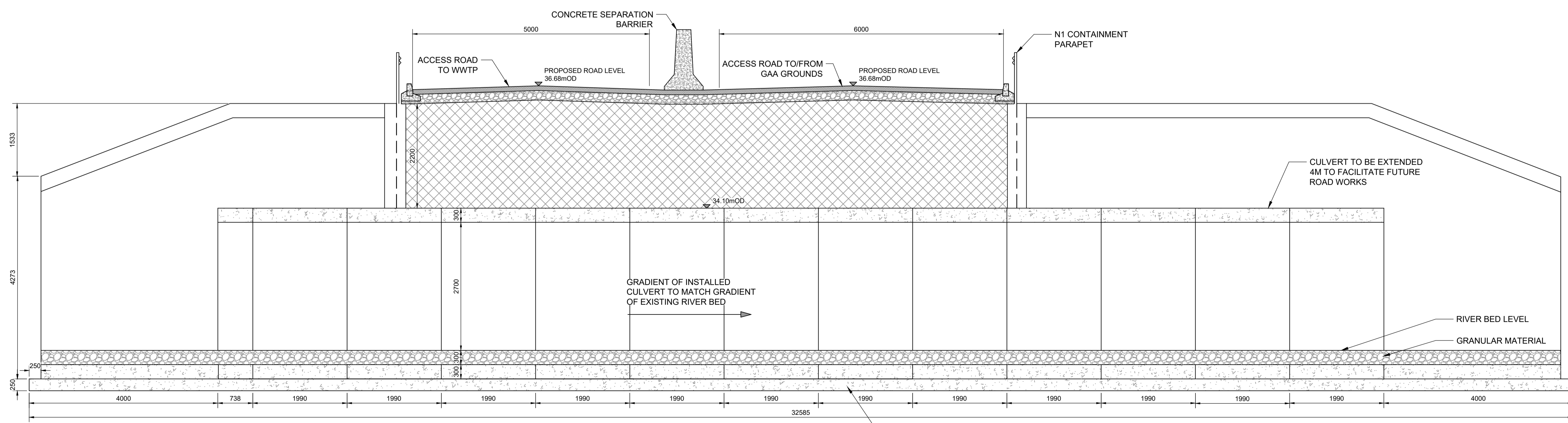

SECTION A-A
Scale 1:50

Key Plan:



Notes:

1. Figured dimensions only to be taken from this drawing.
2. All drawings to be checked by the Contractor on site.
3. Engineer/Employers representative, as appropriate, to be informed by the Contractor of any discrepancies before any work commences.
4. The Contractor shall undertake a thorough check for the actual location of all services/utilities, above and below ground, before any work commences.
5. All levels shown relate to ordnance survey datum at main head.
6. Rock armour in the form of suitably sized boulders and stones to be provided at inlet and outlet of culverts to minimise width of river to width of culverts. base rock to be bedded a minimum depth of 450mm below existing river bed level. min boulder size to be 500kg in size.

| | | | | |
|-----|----------|------------------------------|-----|------|
| P02 | 09.10.23 | Issued for Planning Remittal | MP | OA |
| P01 | 15.12.22 | Issue for Planning | AOC | BD |
| Rev | Date | Description | By | Chkd |



Client:
Uisce Éireann
Irish Water

Project:
GREATER DUBLIN DRAINAGE PROJECT

Drawing Title:
PROPOSED CULVERT AT MAYNE RIVER CROSSING - WWTP ACCESS ROAD SHEET 1 OF 2

Scale @ A1 (DO NOT SCALE): AS SHOWN @ A1
Prepared by: M. O'Neill
Checked by: C. O'Keefe
Date: 06-12-22

Project Manager: Jillian Bolton
Jacobs Number: 32102902
Drawing Status: Issued for Planning Remittal

Drawing No.: 32102902-2148
Revision: P02



This drawing is not to be used in whole or part other than for the intended purpose & project as defined on this drawing. Refer to the contract for full terms and conditions.