

- LEGEND:**
- PLANNING BOUNDARY —
 - CONSTRUCTION COMPOUNDS
 - PROPOSED WWTP/IPS
 - PROPOSED ORBITAL SEWER ROUTE (GRAVITY) —
 - PROPOSED ORBITAL SEWER ROUTE (RISING MAIN) —
 - PROPOSED OUTFALL PIPELINE ROUTE (LAND BASED SECTION) —
 - PROPOSED OUTFALL PIPELINE ROUTE (MARINE SECTION) —
 - PROPOSED TRENCHLESS SECTION
 - MANHOLE (MH-1)
 - ACCESS CHAMBER (AC-1)
 - AIR VALVE (AV-1)
 - SCOUR VALVE (SCV-1)

PROPOSED OUTFALL PIPELINE (LAND BASED SECTION)
CHAINAGE: 3+200 TO 5+379
Scale 1:5,000

OSI 1:2,500 Sheet No's:
 3062-D, 3063-C, 3063-D, 3064-C, 3064-D, 3130-A, 3130-B, 3130-C, 3130-D, 3131-A

OSI 1:1,000 Sheet No's:
 3063-12, 3063-13, 3063-14, 3064-11, 3064-12, 3129-15, 3129-20, 3129-25, 3130-06, 3130-07, 3130-11, 3130-12, 3130-15, 3130-16, 3130-17, 3130-21, 3130-22, 3131-01, 3131-06, 3131-07.

- NOTES:**
- FIGURED DIMENSIONS ONLY TO BE TAKEN FROM THIS DRAWING.
 - ALL DRAWINGS TO BE CHECKED BY THE CONTRACTOR ON SITE.
 - ENGINEER/EMPLOYERS REPRESENTATIVE, AS APPROPRIATE, TO BE INFORMED BY THE CONTRACTOR OF ANY DISCREPANCIES BEFORE ANY WORK COMMENCES.
 - THE CONTRACTOR SHALL UNDERTAKE A THOROUGH CHECK FOR THE ACTUAL LOCATION OF ALL SERVICES/UTILITIES, ABOVE AND BELOW GROUND, BEFORE ANY WORK COMMENCES.
 - ALL LEVELS SHOWN RELATE TO ORDNANCE SURVEY DATUM AT MALIN HEAD.

Rev	Date	Description	By	Chkd.
P01	08.06.18	ISSUE FOR PLANNING	AOC	BD

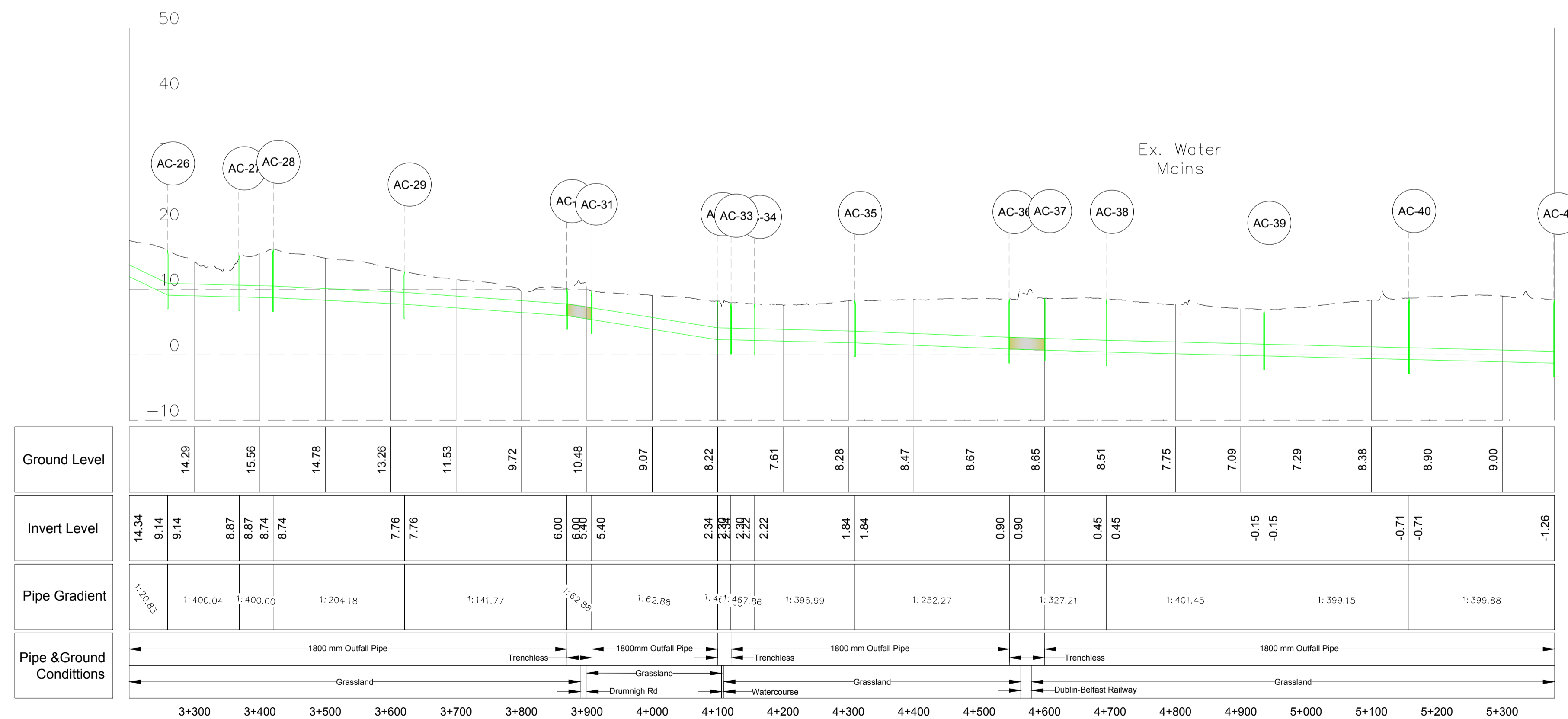

PROPOSED OUTFALL PIPELINE (LAND BASED SECTION)
CHAINAGE: 3+200 TO 5+379
Scale H-1:5,000 / V-1:500

Client: **UISCE EIREANN - IRISH WATER**

Project: **Greater Dublin Drainage**

Title: **PROPOSED OUTFALL PIPELINE ROUTE (LAND BASED SECTION) - Sheet 2 of 2 -**

Scale @ A1: **As Shown**

Prepared by: **A. O'Callaghan** Checked: **B. Downes** Date: **June 2018**

Project Director: **C. O'Keefe**

Drawing Status: **Planning**

JACOBS TOBIN

Drawing No.: **32102902-2105P01**