

PLANT SCHEDULE

- | | | | |
|---------------------------------|--------------------------------|------------------------|------------------------|
| Tree Species | Hedgerow/ Shrub Species | Aquatic Species | Meadow Planting |
| Alnus glutinosa (Common Alder) | Corylus avellana (Hazel) | Typha latifolia | Alexanders |
| Betula pendula (Common Birch) | Crataegus monogyna (Hawthorn) | Iris pseudocorus | Upright Hedge Parsley |
| Fraxinus excelsior (Common Ash) | Ilex aquifolium (Holly) | Glyceria maxima | Weld-Yellow weed |
| Pinus sylvestris (Scots Pine) | Prunus spinosa (Blackthorn) | Bulmus umbellatus | Wild Angelica |
| Quercus robur (Oak) | Rosa canina (Dog Rose) | Juncus effusus | White Bedstraw |
| Sorbus aucuparia (Rowan) | Sambucus nigra (Elder) | Carex paniculata | Bladder Campion |
| Sorbus aria (Whitebeam) | | Shoenpectus lacustris | Ox-eye Daisy |
| Fagus sylvatica (Beech) | | Filipendula ulmaria | Yarrow |
| Prunus avium (Wild Cherry) | | | Corn poppy |
| | | | Corncockle |
| | | | Scented Mayweed |

NOTE: CONFIDENTIAL NO THIRD PARTY DISCLOSURE ALLOWED
 All rights reserved.
 © J.B. Barry and Partners
 T.J. O'Connor and Associates
 Royal HaskoningDHV 2014

All levels are in metres and relate to O.S. Datum MGLN.
 2. This drawing is reproduced from digital maps:
 O.S. MAPS - Scale 1:2,500
 O.S. MAPS - Scale 1:1,250
 Discovery Series - Scale 1:50,000
 3. All Maps are referenced to IRISH NATIONAL GRID (I.T.M.)
 4. Reproduced from the Ordnance Survey of Ireland by Permission of the Government. License No. 3/3/14.

- LEGEND:**
- SITE DEVELOPMENT BOUNDARY
 - BOUNDARY WALL (TYPE 1)
 - CHAINLINK FENCING (TYPE 2)
 - PALISADE FENCING (TYPE 3)
 - EXISTING ROADS & FOOTPATH
 - PROPOSED ROADS & FOOTPATH
 - REINFORCED GRASS
 - GRASS/LANDSCAPING
 - WILD MEADOW
 - EXISTING MIXED PLANTING TO SOUTHERN BOUNDARY BERM
 - LANDSCAPING BERM
 - PROPOSED TREES AND SHRUBS
 - PROPOSED SWALES
 - PROPOSED HEDGEROW TO BOUNDARY
 - EXISTING KERB AND VERGE
 - PROPOSED KERB AND VERGE

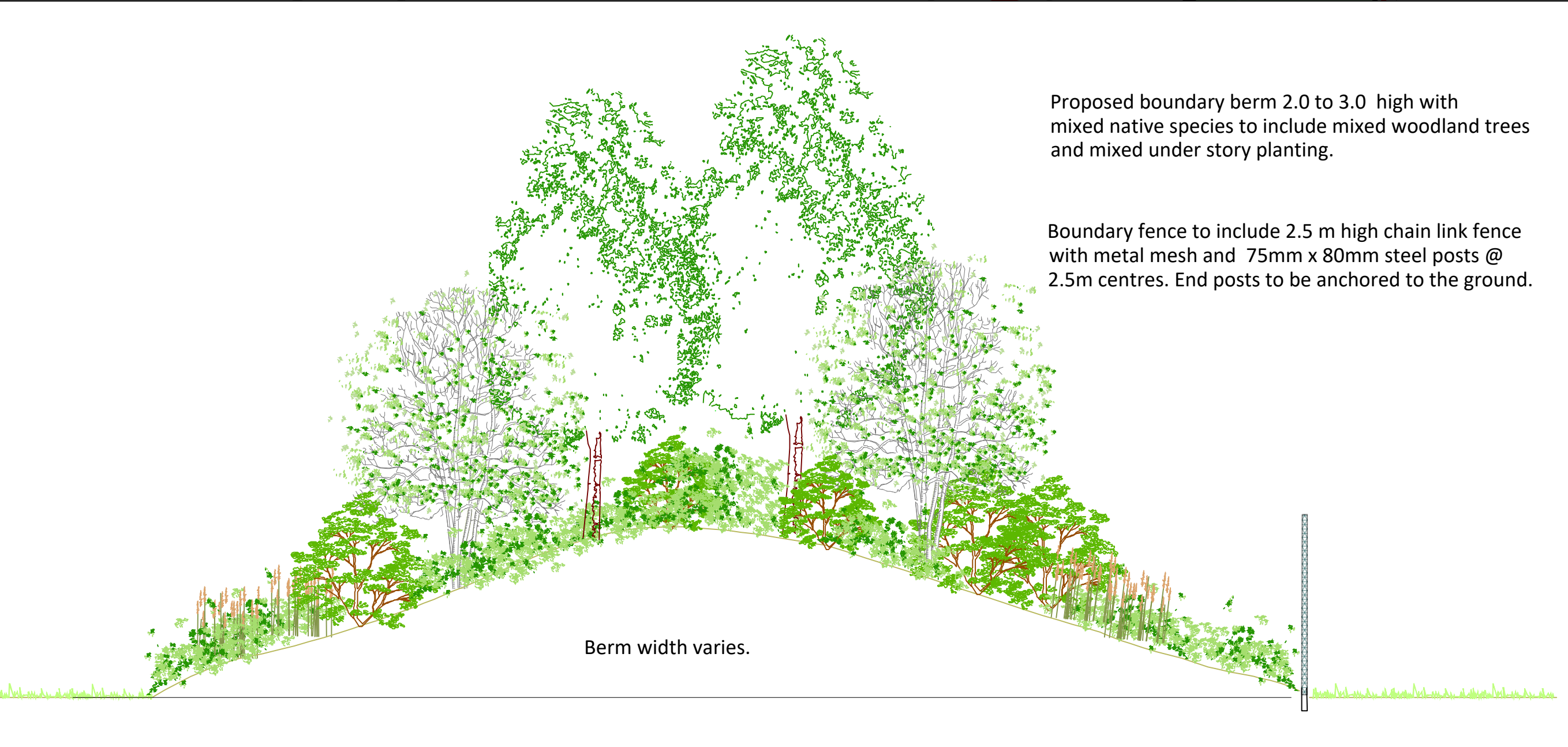
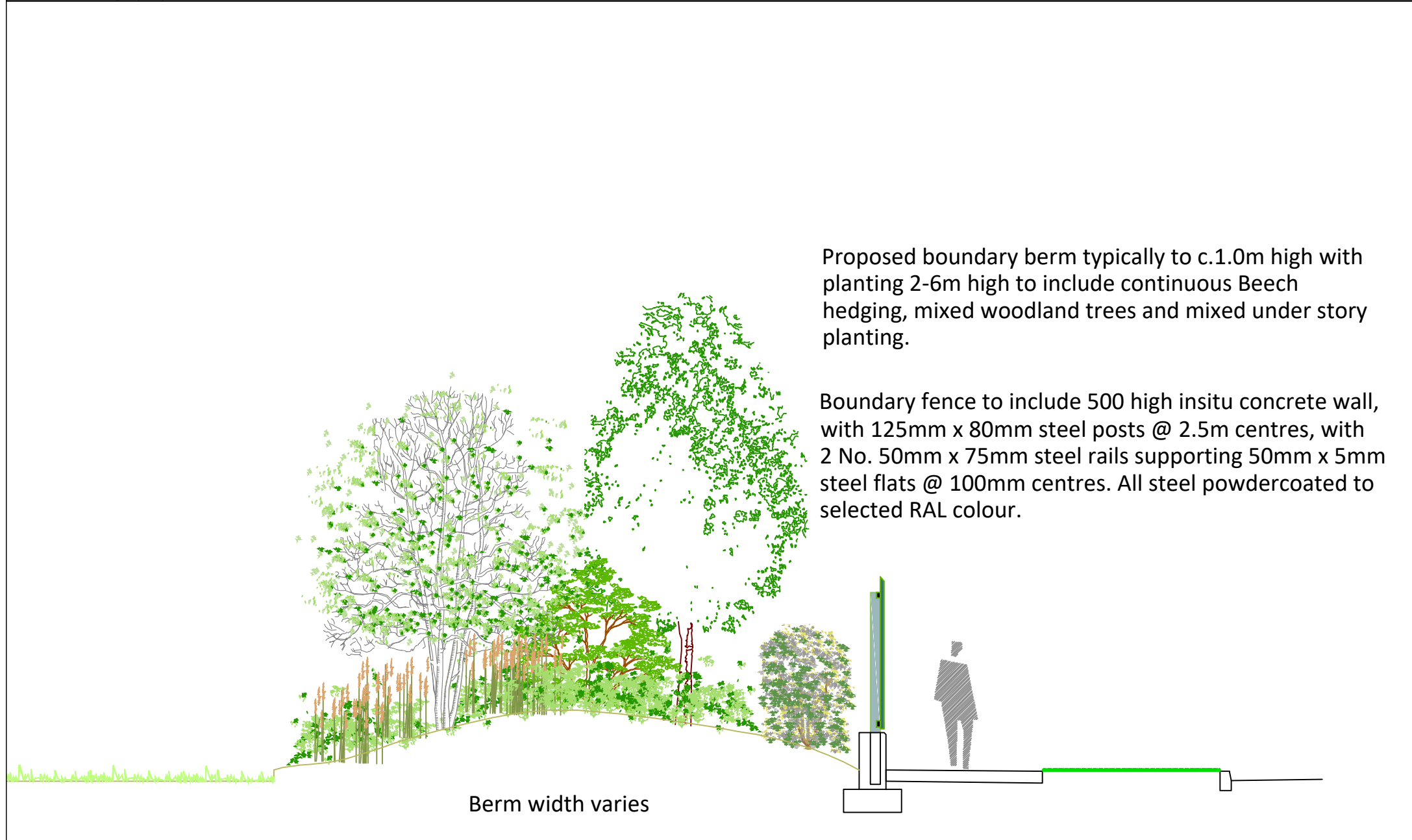
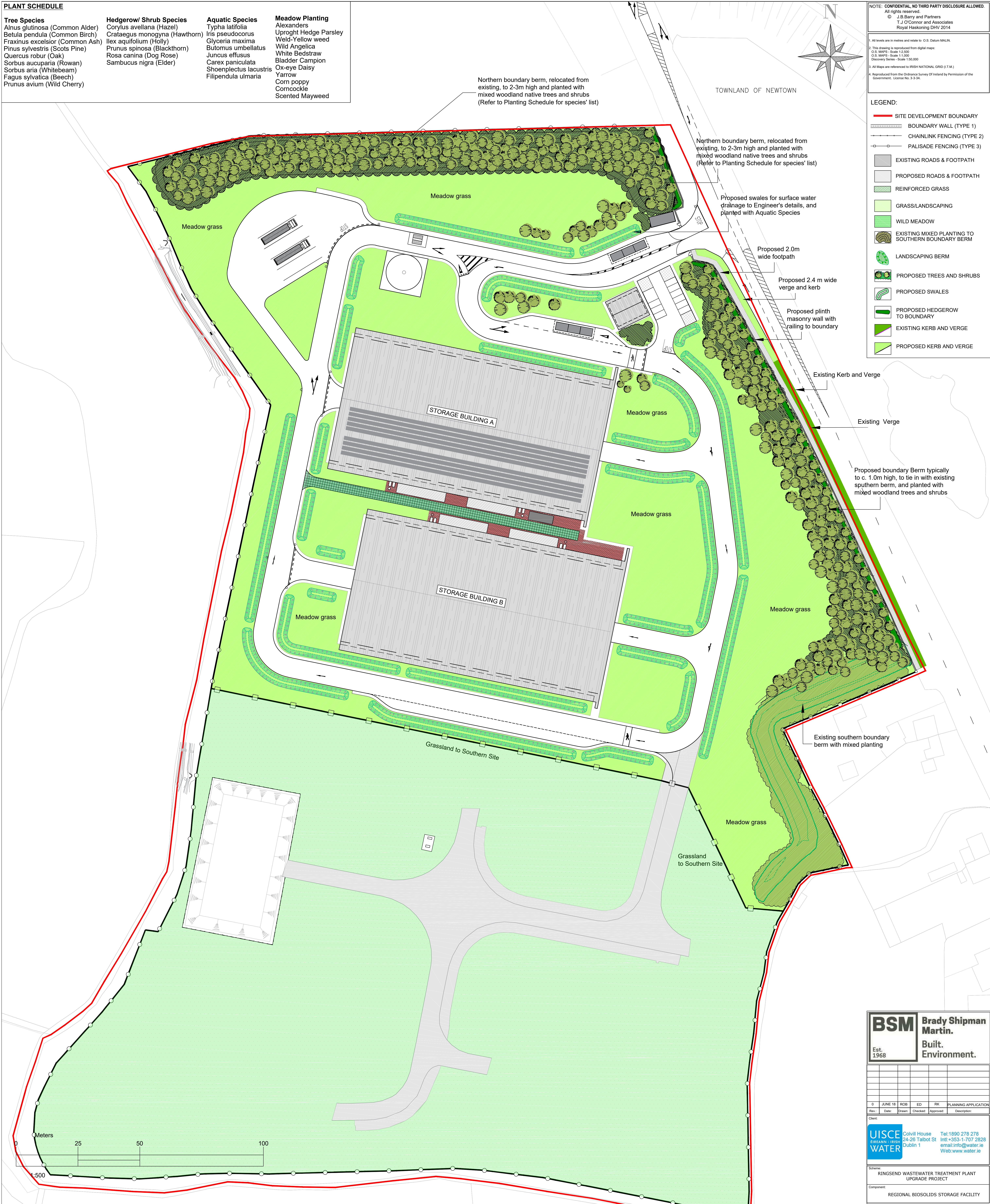

BSM Brady Shipman Martin.
 Est. 1968
 Built. Environment.

Rev.	Date	Drawn	Checked	Approved	Description
0	JUNE 18	ROB	ED	RK	PLANNING APPLICATION

UISCE WATER
 Colville House
 24-26 Talbot St
 Dublin 1
 Tel: 1890 278 278
 Int: +353-1-707 2528
 email: info@uisce.ie
 Web: www.uisce.ie

Scheme: RINGSEND WASTEWATER TREATMENT PLANT UPGRADE PROJECT
 Component: REGIONAL BIOSOLIDS STORAGE FACILITY

TJ O'CONNOR & ASSOCIATES
 Conry Road,
 Sandymount,
 Dublin 18, Ireland
 Tel: +353-1-2952321
 email: tjoc@tjoc.ie
 Web: www.tjoc.ie

J. B. Barry and Partners
 Clason House
 Dundrum Business Park
 Dundrum Road
 Dublin 14
 Tel: +353-1-485 1400
 email: info@jbbp.ie
 Web: www.jbbp.ie

Royal HaskoningDHV
 PO Box 1132
 3800 RC Amersfoort
 The Netherlands
 Tel: +31-88-1482000
 email: info@rhdhv.com
 Web: www.rhdhv.com

Drawn By: ROB	Checked By: ED	Approved By: RK	Date: JUN 2018
Client Project Ref: RW-RGD/10000308	Project Stage: PLANNING	Internal Project Ref: Ring01JBB-Y17702TJOC-14040RHDHV-BB4342	
Drawing Title: LANDSCAPE LAYOUT			
Scale: 1:500(A0) NTS(A3)			
Drawing Register No: 011	Drawing No: Y17702-PL-011	Rev: 0	